

# MEETINGS & TRAINING

## Leonardo Royal London City



Leonardo  
Royal Hotel  
London City

### **For Meeting enquiries**

Tel: 0845 525 6338 Email: [meet@leonardohotels.co.uk](mailto:meet@leonardohotels.co.uk)

For all other enquiries, contact the Hotel directly

### **Leonardo Royal London City**

8-14 Cooper's Row, London EC3N 2BQ

Tel: 020 7863 3700

Email: [londoncityevents@leonardohotels.co.uk](mailto:londoncityevents@leonardohotels.co.uk)

Leonardo  
Hotels



# Welcome to Leonardo Royal London City

**Our extensive and flexible range of meeting rooms are the ideal venue for training, residential training and small meetings.**

## **TRAINING FOR UP TO 120 PEOPLE**

Leonardo Royal London City offers 10 rooms suitable for training. All of our training and syndicate rooms are equipped with TVs and LCD projectors that can be connected to a laptop or portable device.

Featuring state of the art equipment as well as our dedicated team who are at your service, these rooms can be set up as U-shape, Cabaret, Boardroom, Classroom or Theatre style.

## **SMALL TO MEDIUM SIZE MEETINGS UP TO 50 PEOPLE**

Leonardo Royal London City offers 9 meeting rooms suitable for small to medium size meetings. All of our small to medium sized meeting rooms boast the same flexibility and technology as our training rooms and feature natural daylight in a modern surrounding.

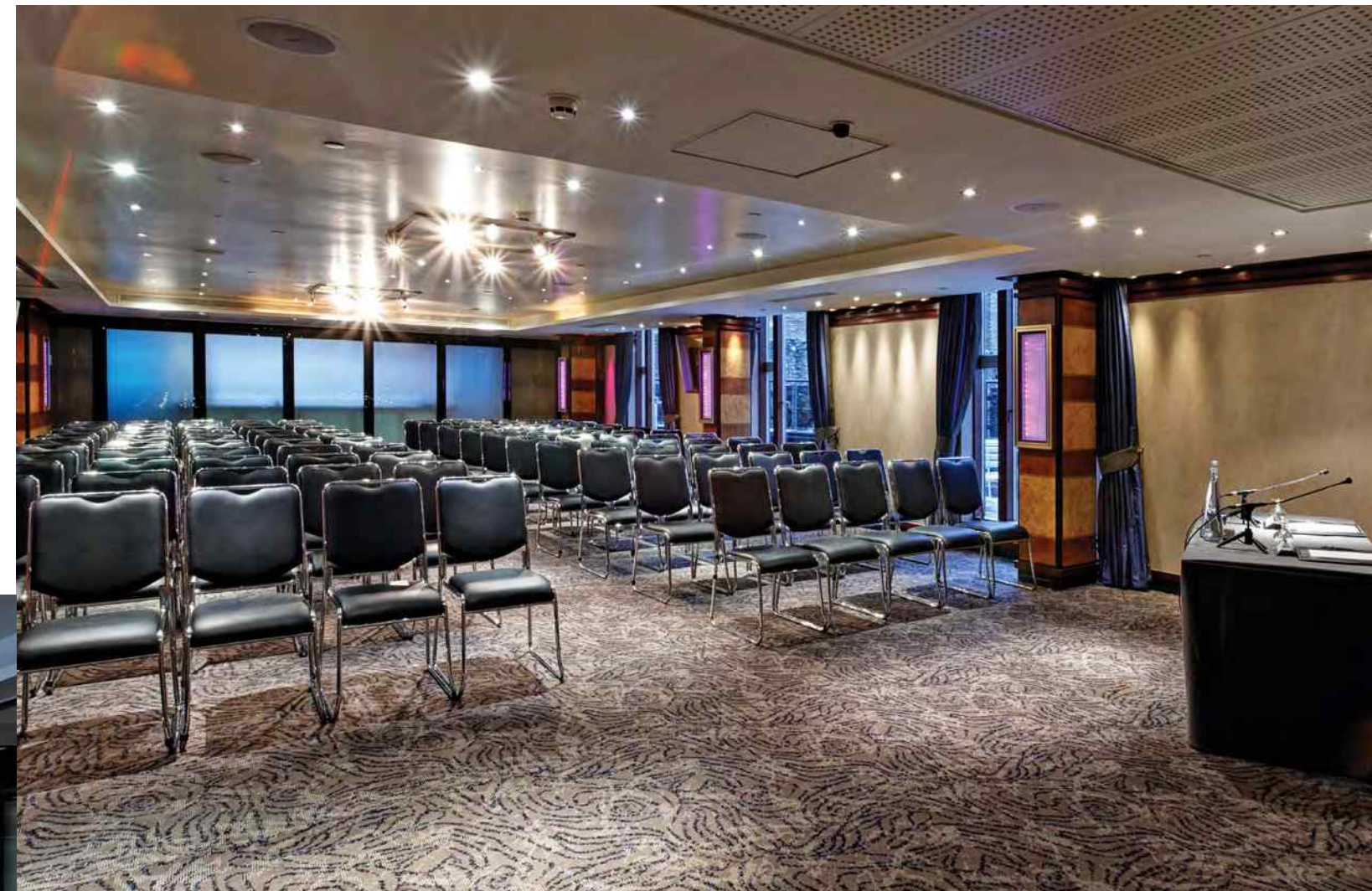



## What We Offer

Here at Leonardo Royal London City we provide the space, style and attention to detail that you want and expect.

Our dedicated Meetings team will ensure your event runs smoothly and all our meeting rooms are located on the first floor.

### Our Meeting and Event Rooms include as standard:

- LCD Screen and Projector
- Natural daylight
- Flexible space
- High speed WiFi
- Air conditioning
- LED Coffers

Supported by our dedicated team who will ensure your meeting or event is a success.

### Location

Leonardo Royal London City boasts a fantastic location close to the iconic Tower of London and a short walk from Tower Hill Underground Station and Tower Gateway DLR Station giving easy access to both major financial institutions and London's most vibrant tourist attractions.

### Location highlights

- 1 minute walk away from Tower Hill Underground station
- 5 minute walk from Tower Gateway DLR Station
- 7 miles from London City Airport
- 18.5 miles from London Heathrow Airport

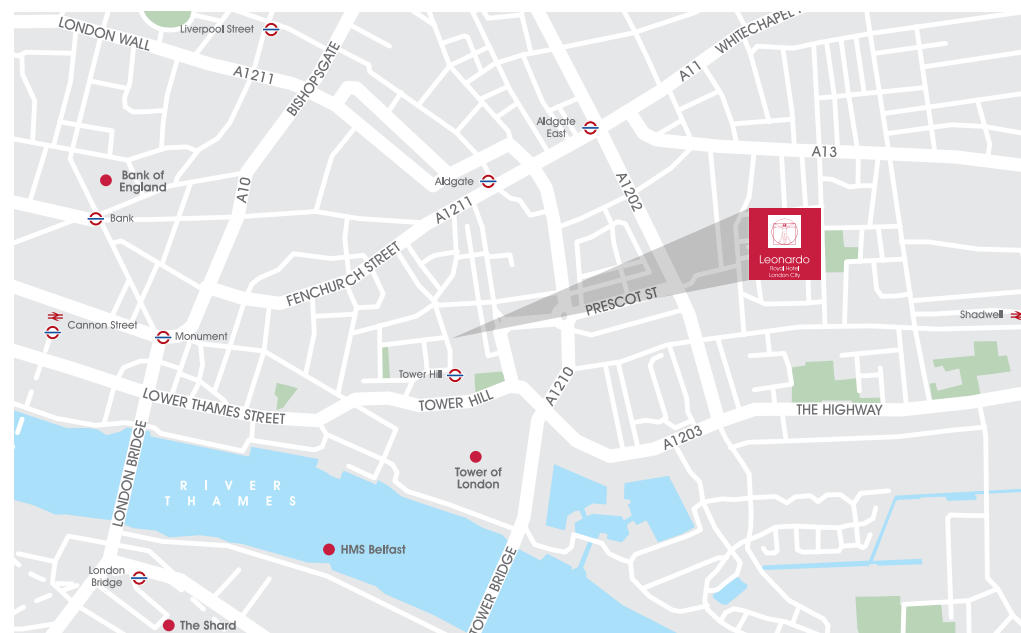

## Floor Plans and Capacities

Floor 1

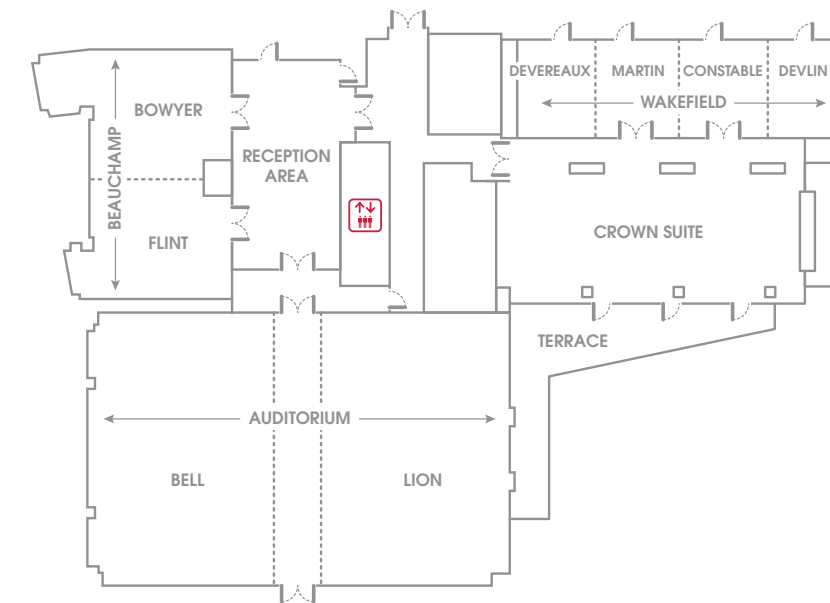

### CAPACITIES AND DIMENSIONS

Room Name	Dimensions L x W x H (m)	Theatre	Boardroom	Classroom	Cabaret	U-Shape	Dinner Dance	Reception
Auditorium	15.2 x 22.8 x 5.2	500	72	260	256	80	340	550
Lion Suite	15.2 x 10.4 x 5.2	200	54	84	96	46	120	200
Bell Suite	15.2 x 10.4 x 5.2	200	54	90	96	46	120	200
Beauchamp Suite	7.7 x 13.9 x 2.4	120	40	60	64	38	90	110
Flint Suite	7.7 x 7 x 2.4	50	20	21	16	18	40	50
Bowyer Suite	7.7 x 6.7 x 2.4	50	20	21	16	18	40	50
Crown Suite	16.9 x 6.6 x 2.4	120	40	64	64	42	90	120
Gallery	19 x 3.9 x 2.4	-	-	-	-	-	0	150
Wakefield Suite	16.4 x 5.4 x 2.2	120	40	48	48	36	60	100
Gallery & Wakefield	19 x 9.4 x 2.2	-	-	-	-	-	-	250
Gallery, Wakefield & Crown	16.4 x 18 x 2.2	-	-	-	-	-	-	350
Crown & Wakefield	16.4 x 14.1 x 2.2	-	-	-	-	-	-	250
Devereux Suite	5.4 x 3.1 x 2.4	12	6	6	8	-	10	12
Martin Suite	5.4 x 4.8 x 2.4	20	6	6	8	-	10	12
Constable Suite	5.4 x 4.6 x 2.4	18	6	6	8	-	10	12
Develin Suite	5.4 x 3.7 x 2.4	15	6	6	8	-	10	12
Develin & Constable	8.2 x 4.8 x 2.2	30	18	12	16	-	20	30
Devereux & Martin	7.8 x 4.8 x 2.2	30	18	12	16	-	20	30
Martin, Constable & Develin	11.3 x 4.8 x 2.2	50	24	24	24	24	40	50



## Accommodation and Leisure

**Our 307 stylish and spacious bedrooms are designed with comfort and convenience in mind providing a place to unwind or to catch up on work.**

All of our rooms feature large comfortable beds, work desk with ergonomic chair, flat screen TVs, complimentary high speed WiFi and spacious en-suite bathrooms.

Our Executive rooms and Suites offer added amenities and services including bathrobe and slippers, minibar and access to the business lounge.





## At a Glance

- 307 stylish and spacious bedrooms including executive rooms and suites
- 12 state of the art meeting and event rooms
- Forum restaurant
- Koto II Japanese Restaurant
- Two On Site Bars
- Health and Leisure Centre including 25m swimming pool
- Spa
- City Virtual Golf

