

CONFERENCES & EVENTS
Leonardo Royal London City



For Conference and Event enquiries

Tel: 0845 525 6338 Email: meet@leonardohotels.co.uk
For all other enquiries, contact the Hotel directly

Leonardo Royal London City

8-14 Cooper's Row, London EC3N 2BQ
Tel: 020 7863 3700
Email: londoncityevents@leonardohotels.co.uk

Leonardo
Hotels

Welcome to Leonardo Royal London City

Our flexible range of 12 meeting and function rooms makes us an ideal venue for hosting small or large conferences and special events.

We can comfortably accommodate up to 550 for standing receptions and 500 delegates in a theatre set up.

Our central and accessible London location and access makes us one of the most convenient conference venues in the city.

Conference and Events

Boasting one large hotel conference room accommodating up to 550 delegates, Leonardo Royal London City is the perfect location to host your large conference or event.



Conference and Events

Auditorium Suite

Situated on the first floor, the Auditorium suite is an impressive meeting space with natural daylight and offers a capacity of 550 for standing receptions and 500 for a theatre set up. The room is suitable for hosting a range of events including large conferences, AGMs, exhibitions and product launches.

This room is fully air conditioned and decorated in a neutral colour scheme with modern wood panelling, boasting beautiful high ceilings and pin-spot lights which can be altered to create the perfect ambience for any event.

Lion and Bell Suites

The Lion and Bell Suites have a capacity for 200 in a theatre set up and standing receptions. Featuring state of the art equipment, the Lion and Bell Suites are suitable for hosting exhibitions, live webcasting sessions, conferences and AGMs.

Our facilities are suitable for:

- Large conferences for up to 550 delegates
- AGMs
- Training Events
- Association and Club Events
- Fundraisers
- Exhibitions
- Team Building Events
- Private Parties

From the latest equipment to freshly brewed tea and coffee and flexible food and drink menus, you'll find everything you need to make your meeting or event a success.



Social Banqueting

Leonardo Royal London City is the perfect location to host your social evening event or corporate function.

Our experienced and dedicated team will assist in arranging every detail of your event, from décor and catering to live entertainment.

We specialise in:

- Large Gala Dinners
- Award Ceremonies
- School Proms
- Charity Fundraisers
- Black Tie Events
- College Balls

Auditorium Suite

Our largest conference and event room is the premier venue for gala balls, charity events and celebrations and can accommodate up to 340 guests for banquets.

The space benefits from state-of-the-art audiovisual equipment, including HD projectors, full-range speakers, PA system, LCD projectors with screens, and encrypted Wi-Fi links.



What We Offer

Here at Leonardo Royal London City we provide the space, style and attention to detail that you want and expect.

Our dedicated Meetings team will ensure your event runs smoothly and all our meeting rooms are located on the first floor.

Our Meeting and Event Rooms include as standard:

- LCD Screen and Projector
- Natural daylight
- Flexible space
- High speed WiFi
- Air conditioning
- LED Coffers

Supported by our dedicated team who will ensure your meeting or event is a success.

Location

Leonardo Royal London City boasts a fantastic location close to the iconic Tower of London and a short walk from Tower Hill Underground Station and Tower Gateway DLR Station giving easy access to both major financial institutions and London's most vibrant tourist attractions.

Location highlights

- 1 minute walk away from Tower Hill Underground station
- 5 minute walk from Tower Gateway DLR Station
- 7 miles from London City Airport
- 18.5 miles from London Heathrow Airport

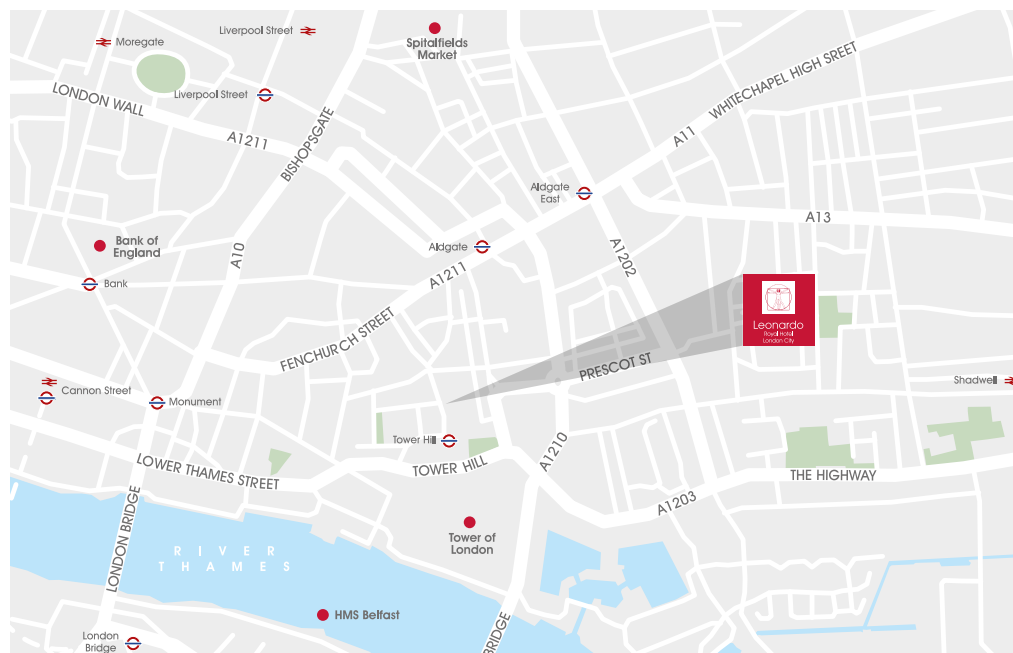

Floor Plans and Capacities

Floor 1

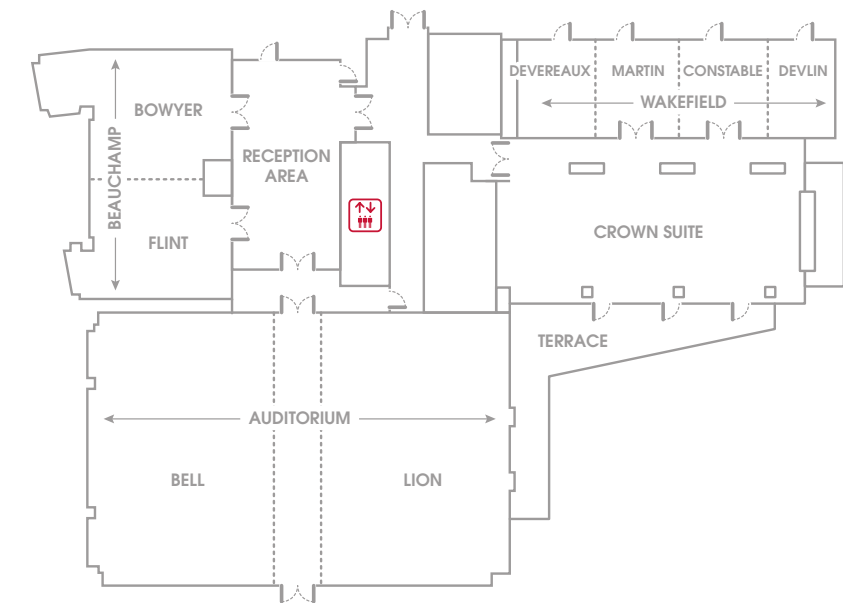

CAPACITIES AND DIMENSIONS

Room Name	Dimensions L x W x H (m)	Theatre	Boardroom	Classroom	Cabaret	U-Shape	Dinner Dance	Reception
Auditorium	15.2 x 22.8 x 5.2	500	72	260	256	80	340	550
Lion Suite	15.2 x 10.4 x 5.2	200	54	84	96	46	120	200
Bell Suite	15.2 x 10.4 x 5.2	200	54	90	96	46	120	200
Beauchamp Suite	7.7 x 13.9 x 2.4	120	40	60	64	38	90	110
Flint Suite	7.7 x 7 x 2.4	50	20	21	16	18	40	50
Bowyer Suite	7.7 x 6.7 x 2.4	50	20	21	16	18	40	50
Crown Suite	16.9 x 6.6 x 2.4	120	40	64	64	42	90	120
Gallery	19 x 3.9 x 2.4	-	-	-	-	-	0	150
Wakefield Suite	16.4 x 5.4 x 2.2	120	40	48	48	36	60	100
Gallery & Wakefield	19 x 9.4 x 2.2	-	-	-	-	-	-	250
Gallery, Wakefield & Crown	16.4 x 18 x 2.2	-	-	-	-	-	-	350
Crown & Wakefield	16.4 x 14.1 x 2.2	-	-	-	-	-	-	250
Devereux Suite	5.4 x 3.1 x 2.4	12	6	6	8	-	10	12
Martin Suite	5.4 x 4.8 x 2.4	20	6	6	8	-	10	12
Constable Suite	5.4 x 4.6 x 2.4	18	6	6	8	-	10	12
Develin Suite	5.4 x 3.7 x 2.4	15	6	6	8	-	10	12
Develin & Constable	8.2 x 4.8 x 2.2	30	18	12	16	-	20	30
Devereux & Martin	7.8 x 4.8 x 2.2	30	18	12	16	-	20	30
Martin, Constable & Develin	11.3 x 4.8 x 2.2	50	24	24	24	24	40	50

At a Glance

- 307 stylish and spacious bedrooms including executive rooms and suites
- 12 state of the art meeting and event rooms
- Forum restaurant
- Koto II Japanese Restaurant
- Two On Site Bars
- Health and Leisure Centre including 25m swimming pool
- Spa
- City Virtual Golf



