

Leonardo Hotel Cardiff

Floorplans and Capacities

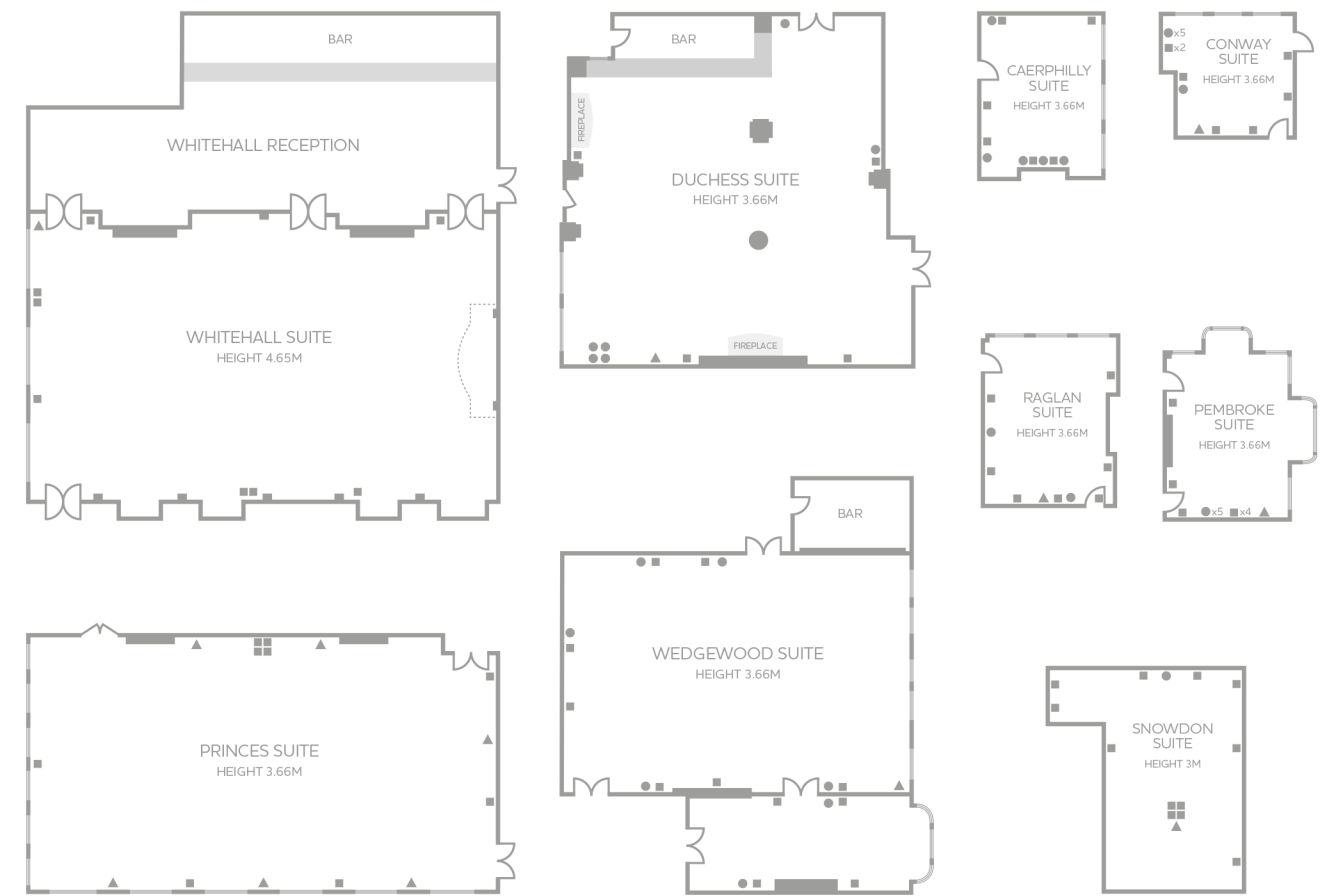

Floor Plans and Capacities



KEY ▲ AERIAL SOCKET ■ 13 AMP SOCKET DOUBLE ● TELEPHONE POINT - - - MOVABLE ACOUSTIC PARTITION

Room Capacities

	Theatre	Theatre (Back Projection)	Classroom	Boardroom	U-Shape	Cabaret (Full rounds)	Cabaret (Half rounds)	Banquet	Dinner Dance	Length (m)	Width	Height	Controls in Room	Tungsten	Dimmers	Blackout	Natural Light	3 Phase	Air Conditioning	Free WiFi
Whitehall Suite	250	200	100	60	50	140	126	150	140	18.21	10.21	4.65	-	-	✓	✓	✓	-	✓	✓
Princes Suite	250	200	100	60	50	140	126	150	140	18.18	9.76	3.66	-	-	✓	✓	✓	-	✓	✓
Duchess Suite	80	50	50	30	30	60	56	80	70	12.47	10.26	3.66	-	-	✓	✓	✓	-	✓	✓
Wedgewood Suite	110	80	50	40	36	80	56	80	70	13.30	9.02	3.66	-	-	✓	✓	✓	-	✓	✓
Snowdon Suite	30	-	20	20	18	15	-	-	-	7.00	8.00	3.00	✓	-	-	✓	✓	-	✓	✓
Raglan Suite	30	-	15	-	-	-	-	-	-	6.22	5.05	3.66	✓	-	-	✓	✓	-	✓	✓
Pembroke Suite	30	-	15	-	-	-	-	-	-	6.10	4.51	3.66	✓	-	-	✓	✓	-	✓	✓
Conway Suite	10	-	8	-	-	-	-	-	-	5.03	4.59	3.66	✓	-	-	✓	✓	-	✓	✓
Caerphilly Suite	15	-	10	-	-	-	-	-	-	6.23	4.55	3.66	✓	-	-	✓	✓	-	✓	✓

Leonardo Hotel Cardiff

For Meeting Enquiries

Tel: 0845 525 6338- Email meet@leonardohotels.com

For other enquiries, contact the hotel directly

Leonardo Hotel Cardiff, 1 Park Place, Cardiff, CF10 3UD
Tel: 0161 774 2983- Email: cardiff_conference@leonardohotels.com